



HELEN SCHULER NATURE CENTRE

OUTDOOR LEARNING CLASSROOM

Draft Concept Package

March 2018



OUTDOOR LEARNING CLASSROOM

HELEN SCHULER NATURE CENTRE

“IF WE WANT CHILDREN TO FLOURISH, TO BECOME TRULY EMPOWERED, THEN LET US ALLOW THEM TO LOVE THE EARTH BEFORE WE ASK THEM TO SAVE IT.”

-DAVID SOBEL

PREPARED BY:
HELEN SCHULER NATURE CENTRE & O2 PLANNING AND DESIGN INC.
03/13/2018

A photograph of a field of globe thistle flowers. The flowers are in various stages of bloom, with some showing vibrant purple and others appearing more white or light pink. They are on tall, green stems. The background is a soft-focus field of similar flowers under a clear blue sky. A white rectangular box is superimposed over the center of the image, containing the text 'PROJECT NARRATIVE' in white, bold, sans-serif capital letters.

**PROJECT
NARRATIVE**

nature-study

The Helen Schuler Nature Centre (HSNC) outdoor learning classroom and amphitheatre replaces an aging outdoor classroom that has reached the end of its usable life-cycle. The new outdoor classroom will provide:

- A functional outdoor space for both small and large groups of students to gather and engage with HSNC staff;
- A presentation and event space for large gatherings;
- A flexible, social space for all park users; and,
- A tranquil location for pause and viewing of the surrounding landscape.

The new space will allow both students and park users time to slow down, explore and reflect upon their natural surroundings. This experience often formulates an emotional connection between people and nature, which in theory can lead to a behavioural change and support for further sustainable practices in the area.

PROPOSED SITE PLAN ▶

CONTEXT PLAN ▼



DIAGRAM NOTES

Gathering Circle 1

A hovering cedar bench creates a gathering circle conducive to learning (max. 32 students)

Amphitheatre Seating 2

A concrete seat wall with cedar slats creates an amphitheatre (max. 17 students)

Stamped Animal Tracks in Concrete 3

Removable Corten Poles 4

Cobble Lined Stormwater Swale 5

Native Plantings 6

Donor Recognition Rocks 7

Donor Recognition Plaque on Backrest 8

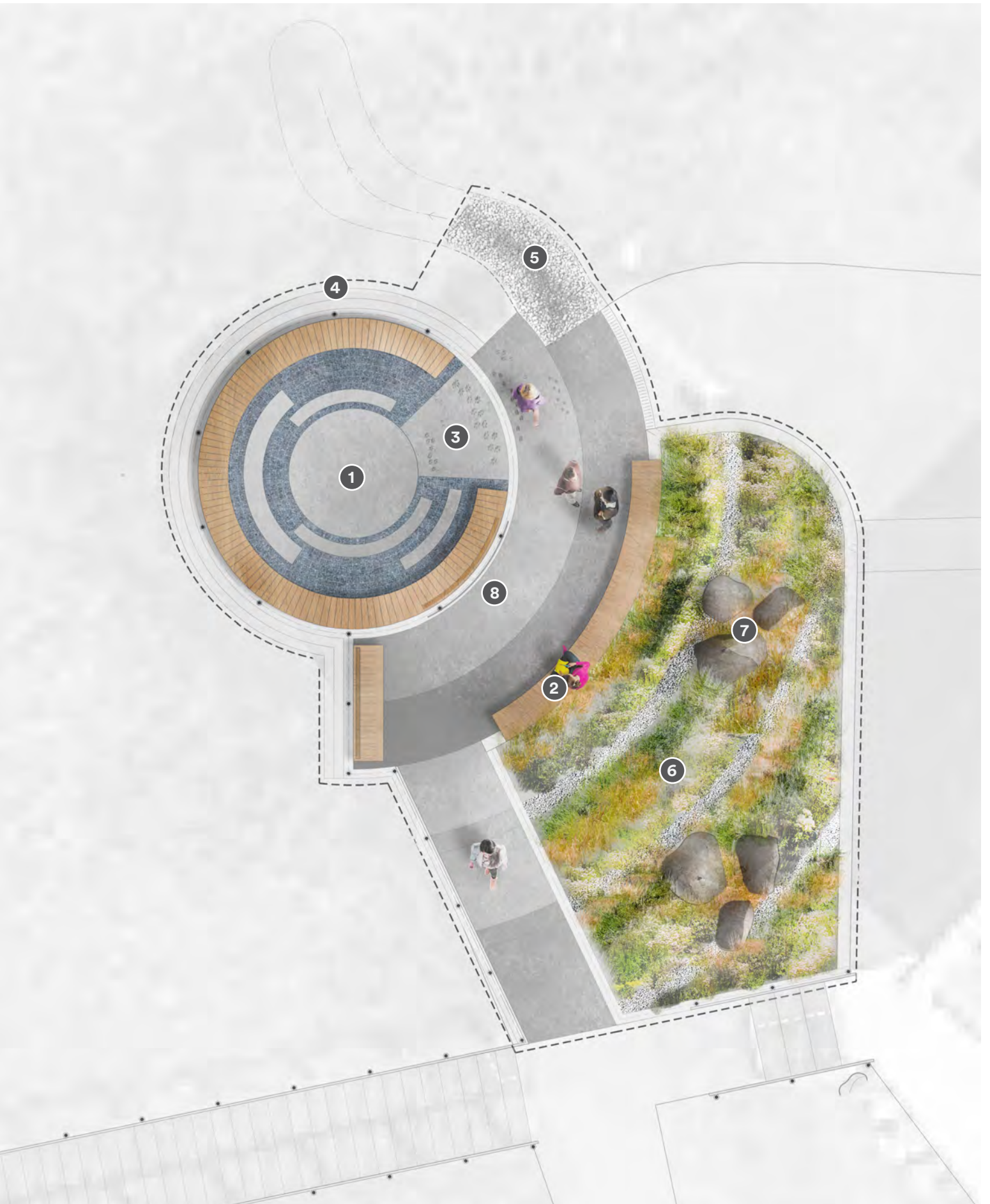



Inner circle can be used for small groups and groups up to 30 students



Permanent pole mounting acts as support for seating.

Stormwater is discharged into the surrounding landscape, creating a unique educational opportunity

Donor recognition rocks are integrated into the natural landscape

Rings of native plantings create a unique habitat for programming and study



CONCEPT RENDERING ▶

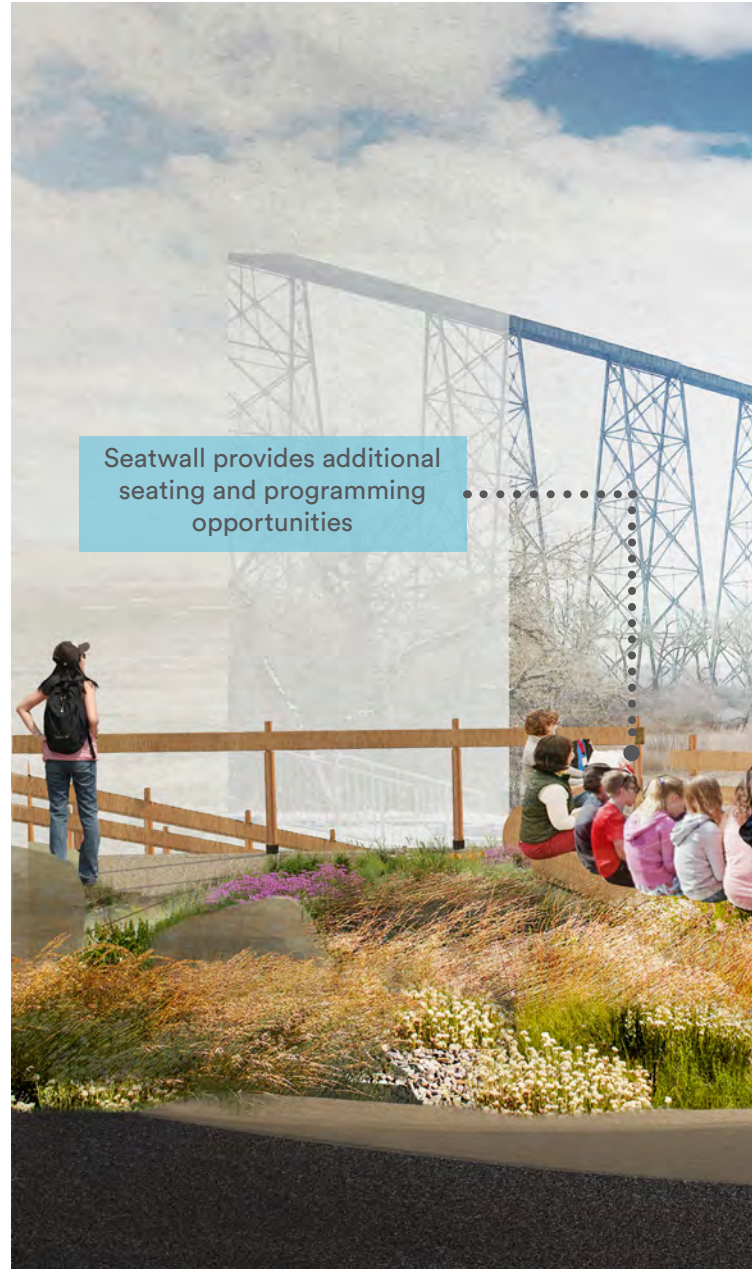

Seatwall provides additional seating and programming opportunities

DETAILS

DONOR RECOGNITION



NATIVE VEGETATION



Poles can be used for a variety of purposes such as holders for event or outdoor exhibition posters, snow fences in the winter, or removed and stored away to ensure landscape views are uninhibited

Animal tracks are stamped into the concrete in successive rings as a playful interpretive element

REMOVABLE EVENT POLES

ANIMAL TRACKS

